



C100-M430.03 K3

Manual tool change

Item no. **11204003**

HF-Spindle for high-speed milling, -grinding, -drilling, -engraving

Bearings

| | |
|---------------------------|------------------|
| Hybrid ball bearing (pcs) | 4 |
| Lifetime lubricated | maintenance free |

Motor

| | |
|--|---|
| Motor technology | 3-phase asynchronous drive (no brushes or sensors) |
| Frequency | 500 Hz |
| Motor poles (pairs) | 1 |
| Rated rotation speed | 30.000 rpm |
| Acceleration/braking value Per second | 10 000 rpm (other values by consultation) |

Power values

Liquid cooled

| | Pmax./5s | S6-60% | S1-100% | |
|-------------|----------|--------|---------|------|
| Rated power | 3,5 | 2,6 | 2,3 | [kW] |
| Torque | 1,24 | 0,96 | 0,82 | [Nm] |
| Voltage | 200 | 200 | 200 | [V] |
| Current | 14 | 10 | 9,5 | [A] |

Power values

Compressed air cooled

| | Pmax./5s | S6-60% | S1-100% | |
|-------------|----------|--------|---------|------|
| Rated power | 3,5 | 1,9 | 1,5 | [kW] |
| Torque | 1,24 | 0,68 | 0,52 | [Nm] |
| Voltage | 200 | 200 | 200 | [V] |
| Current | 14 | 7 | 6 | [A] |

C100-M430.03 K3

Manual tool change
Item no. **11204003**

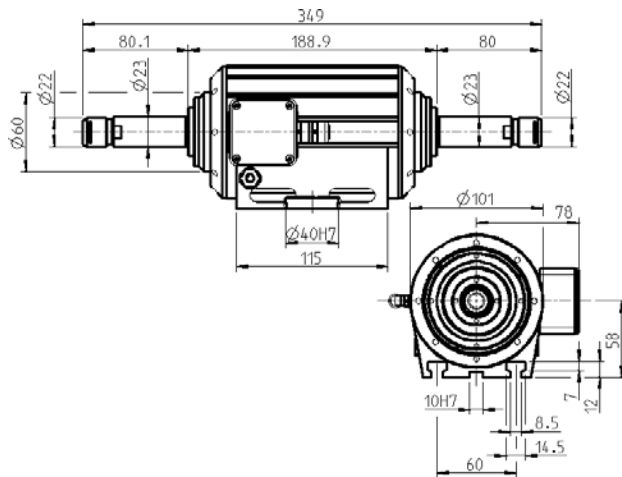

Dimensions

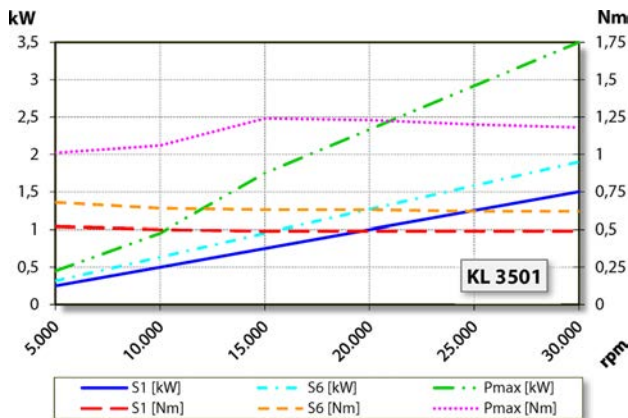

Performance Diagram

Compressed air cooled

Measurement of power is funded by in-house testing.

Characteristics

| | |
|--|--|
| Motor protection | PTC 130°C |
| Housing | Aluminium |
| Housing diameter | 100 mm |
| T-slots | DIN 650-8 |
| Spindle holder integrated | |
| Cooling | Compressed air cooled Liquid cooled |
| Heat dissipation | Via the housing |
| Housing temperature | < + 55° C |
| Ambient temperature | + 10°C ... + 45°C |
| Sealing air | |
| Protection category (sealing air turned on) | IP54 |
| Tool change | Manual tool change |
| Collet type | ER 16 |
| Clamping range up to | 10 mm (25/64") |
| Clockwise rotation on both drive sides | |
| Connection | Cable length 3 m |
| Weight | ~ 9 kg |
| Inner taper run out | < 2 μ |